

Single Row Tapered Roller Bearing

31300 Series-31310J2/QCL7C

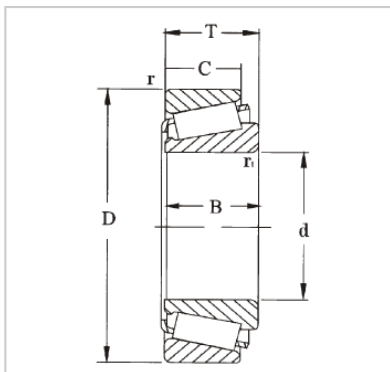

WUXI GUANGQIANG BEARING TRADE CO.,LTD

Обозначение **31310J2/QCL7C**

Основные размеры (мм)

d1 50

D 110

B 29.25

Номинальная грузоподъемность (кН)

dyc (Cr) 122

stc (Cор) 120

Пу 14.3

Номинальная скорость (об / мин)

Рейтинги скорости 4500

Ограничение скорости 6000

Вес (кг) 1.20

ISO335

Размеры (ABMA) 7FB

Размеры (мм)

d 50

d1 □ 81.5

B 27

C 19

r1,2 (мин) 2.5

r3,4 (мин) **2**

a 34

Размеры абатмента и галтели (мм)

да (макс) 62

дБ (мин) 60

Да (мин) 87

Да (макс.) 100

Дб (мин) 104

Са (мин) 4

Сb (мин) **10**ра (макс) **2**rb (макс.) **2**

Ценить

e 0.83

Y 0.72

Эй 0.4

GQZ high quality 31300 Series Single Row Tapered Roller Bearing

Tapered roller bearings have tapered inner and outer raceways and rollers to handle simultaneous radial and thrust loads. Their axial load carrying capacity is directly related to the contact angle of the rollers and raceway shaft.

They are available in single-row, double-row, and four-row designs. The individual parts of tapered

roller bearings are commonly sold separately as cups and cones. Cones contain the roller assembly and inner ring while cups include the outer ring. Full assembly units contain both the cup and cone. As separable bearings, different designs and sizes are available to accommodate a variety of applications.

Wuxi Guangqiang Bearing Trade Co.,Ltd-Tel:86-510-82601571-Email:gq@gqbearing.com,shary@gqbearing.com-http://www.bearing-asia.com